

Front Door Trim Panel



Special Tool(s) / General Equipment

| |
|--------------------------|
| Pick Hook |
| Interior Trim Remover |

Removal

NOTE: Left hand drive (LHD) shown, right hand drive (RHD) similar.

NOTE: Left hand (LH) shown, right hand (RH) similar.

NOTE: Removal steps in this procedure may contain installation details.

1. Release the clips and remove the front door trim panel upper bolts cover.
Use the General Equipment: Interior Trim Remover

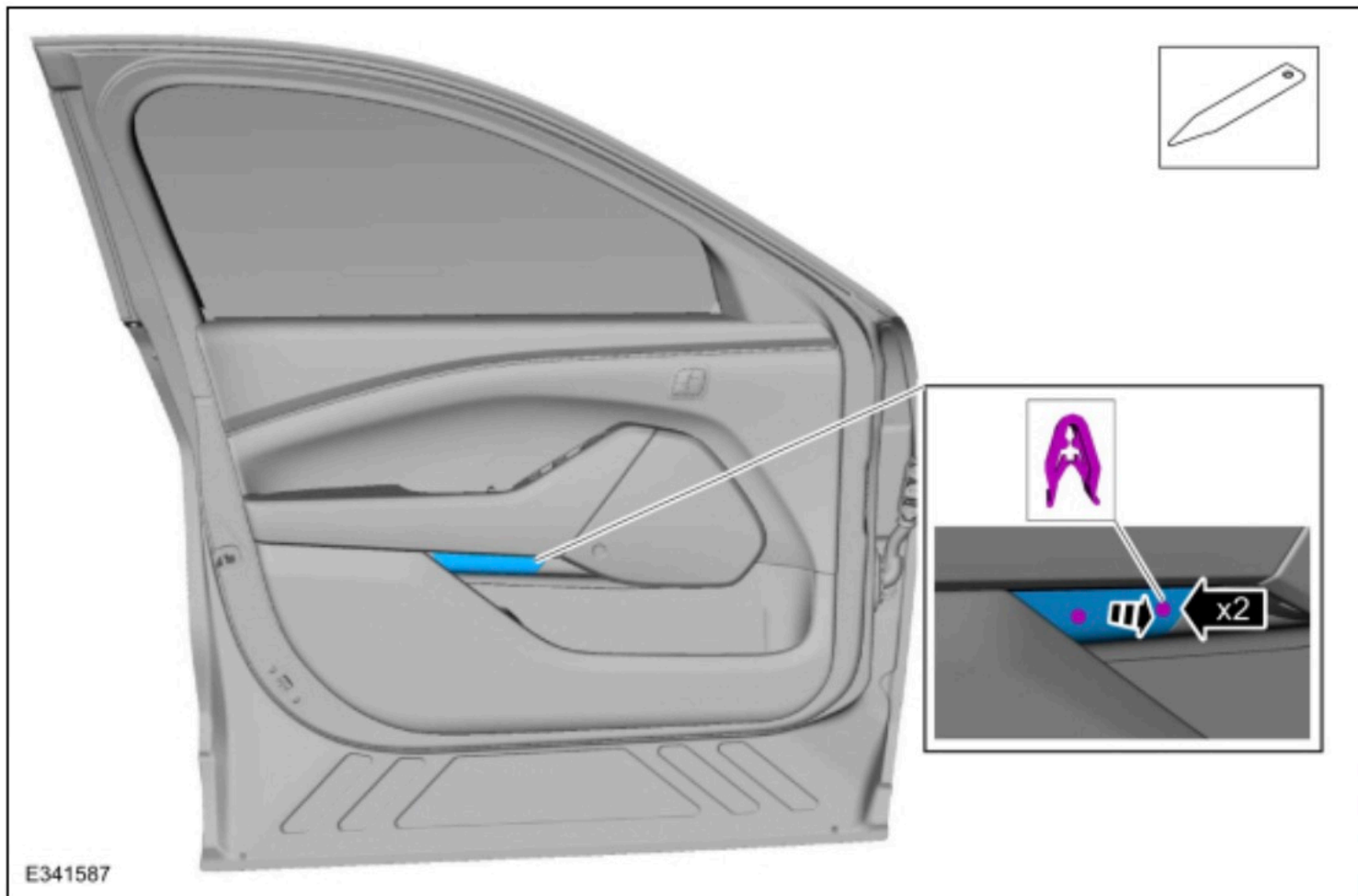

2. Remove the front door trim panel upper bolts.
Torque : 48 lb.in (5.4 Nm)

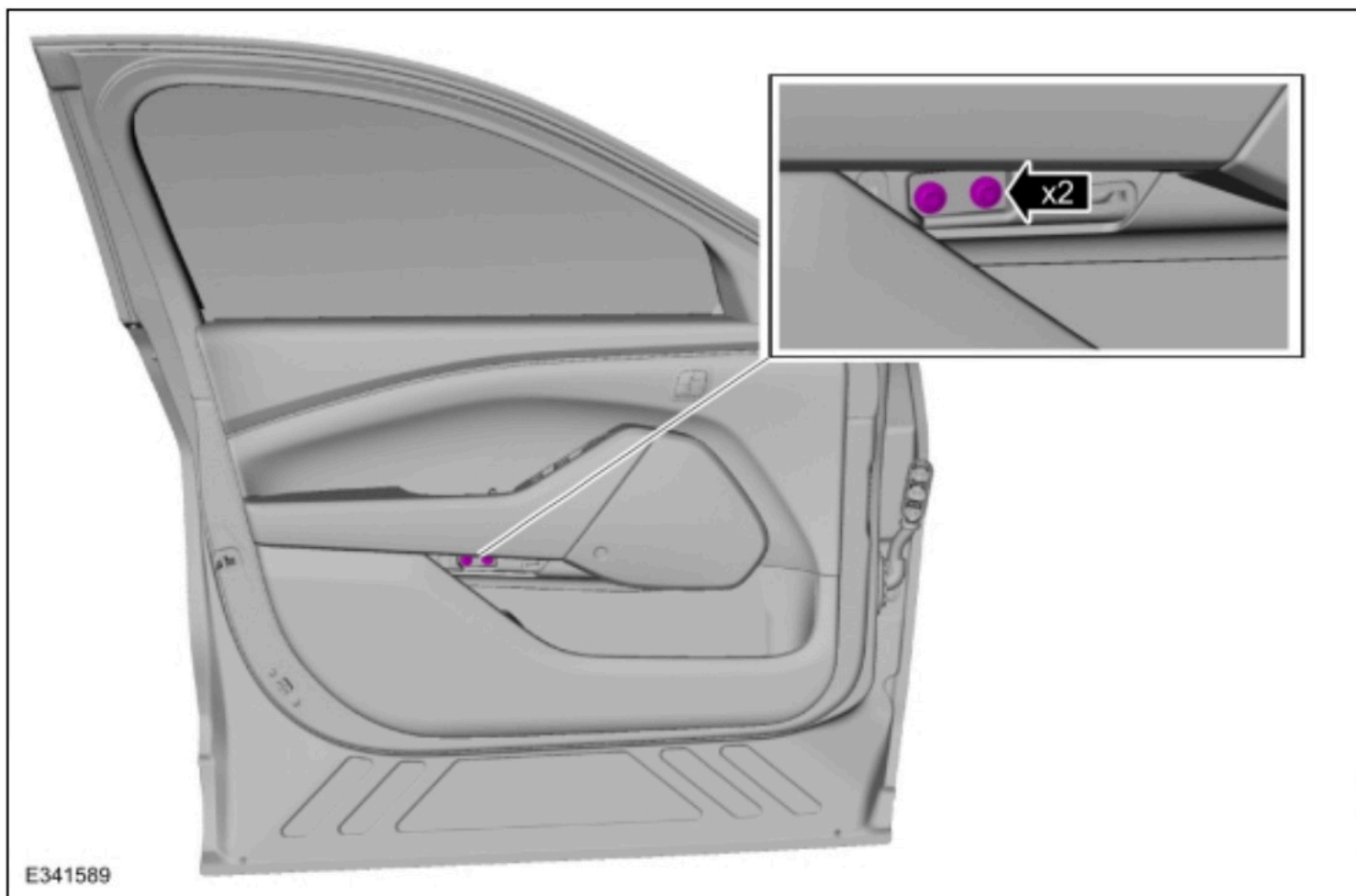

3. Release the tabs and remove the front door trim panel side screw cover.
Use the General Equipment: Pick Hook

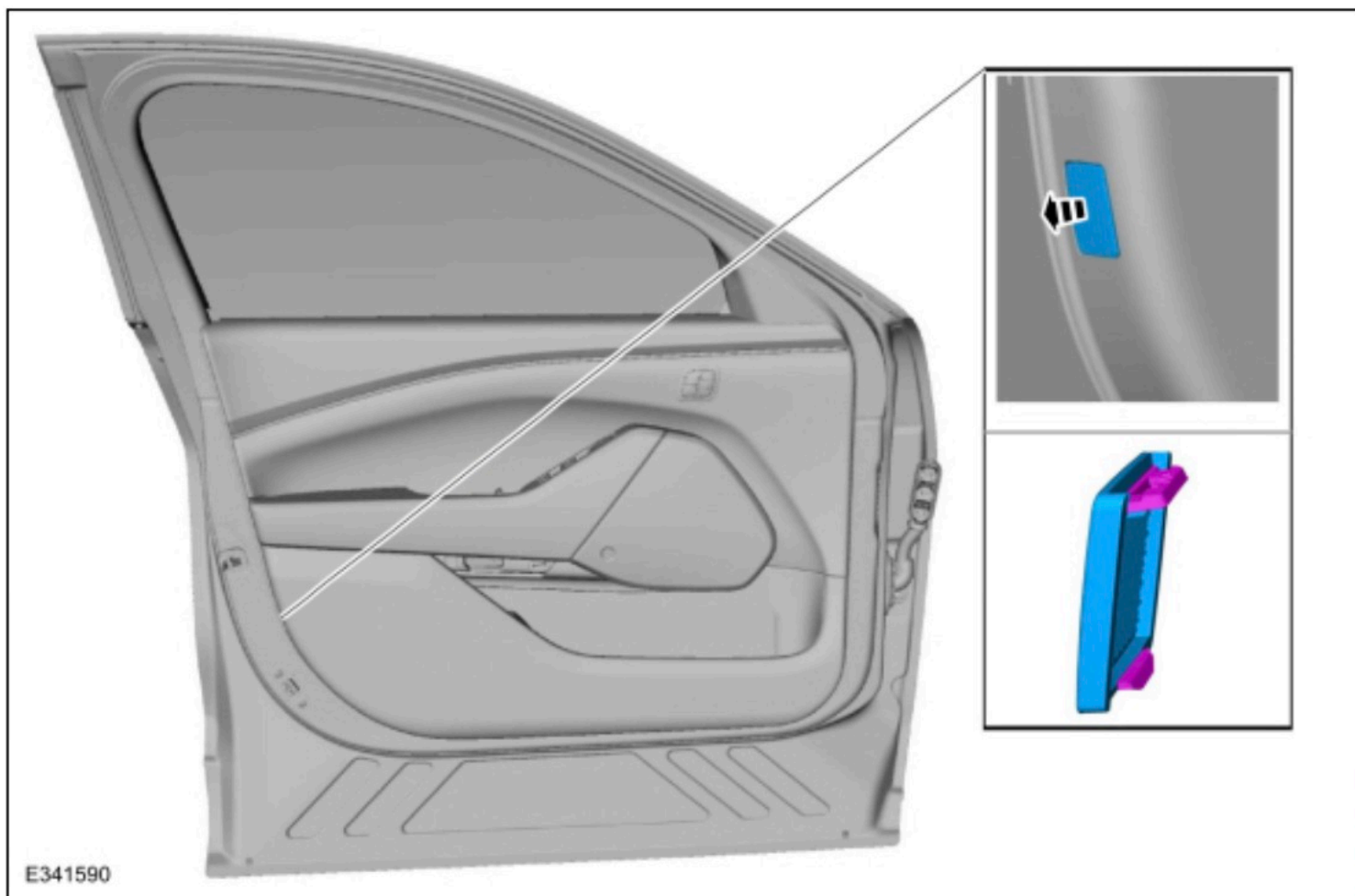

4. Remove the front door trim panel side screw.
Torque : 13 lb.in (1.5 Nm)



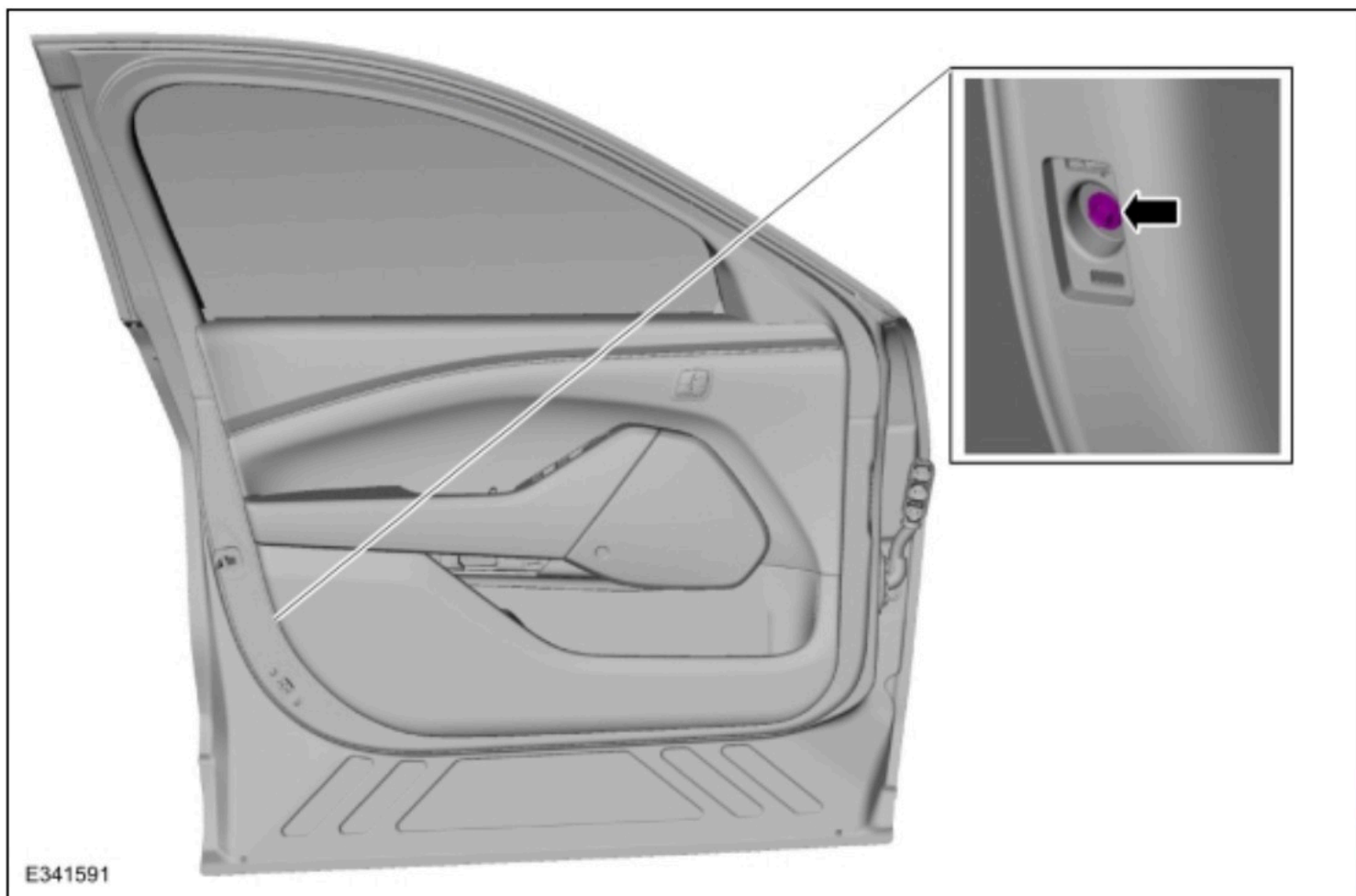

5. Remove the front door trim panel lower bolts.
Torque : 13 lb.in (1.5 Nm)

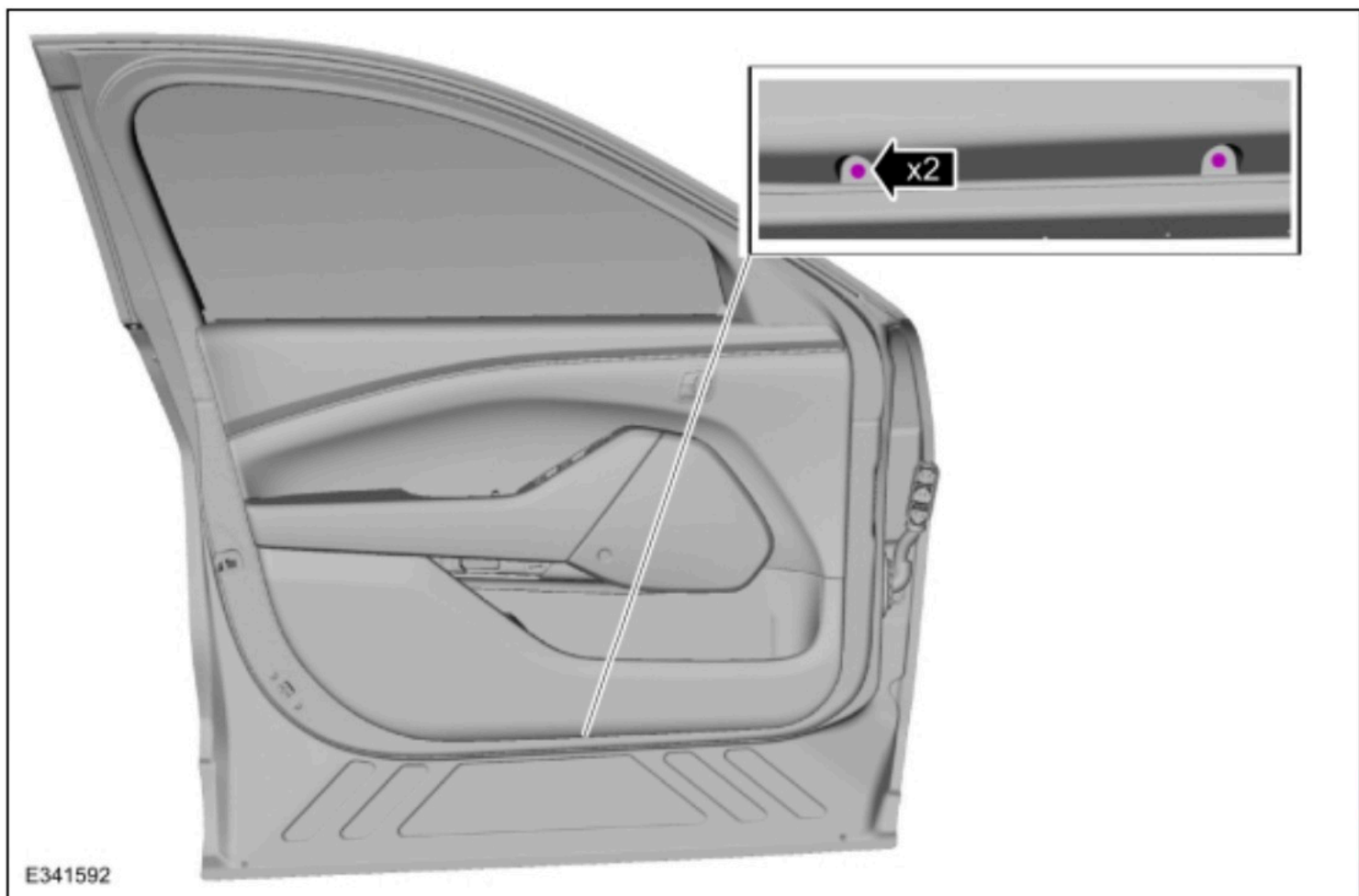

6. Release the front door trim panel clips.
Use the General Equipment: Interior Trim Remover

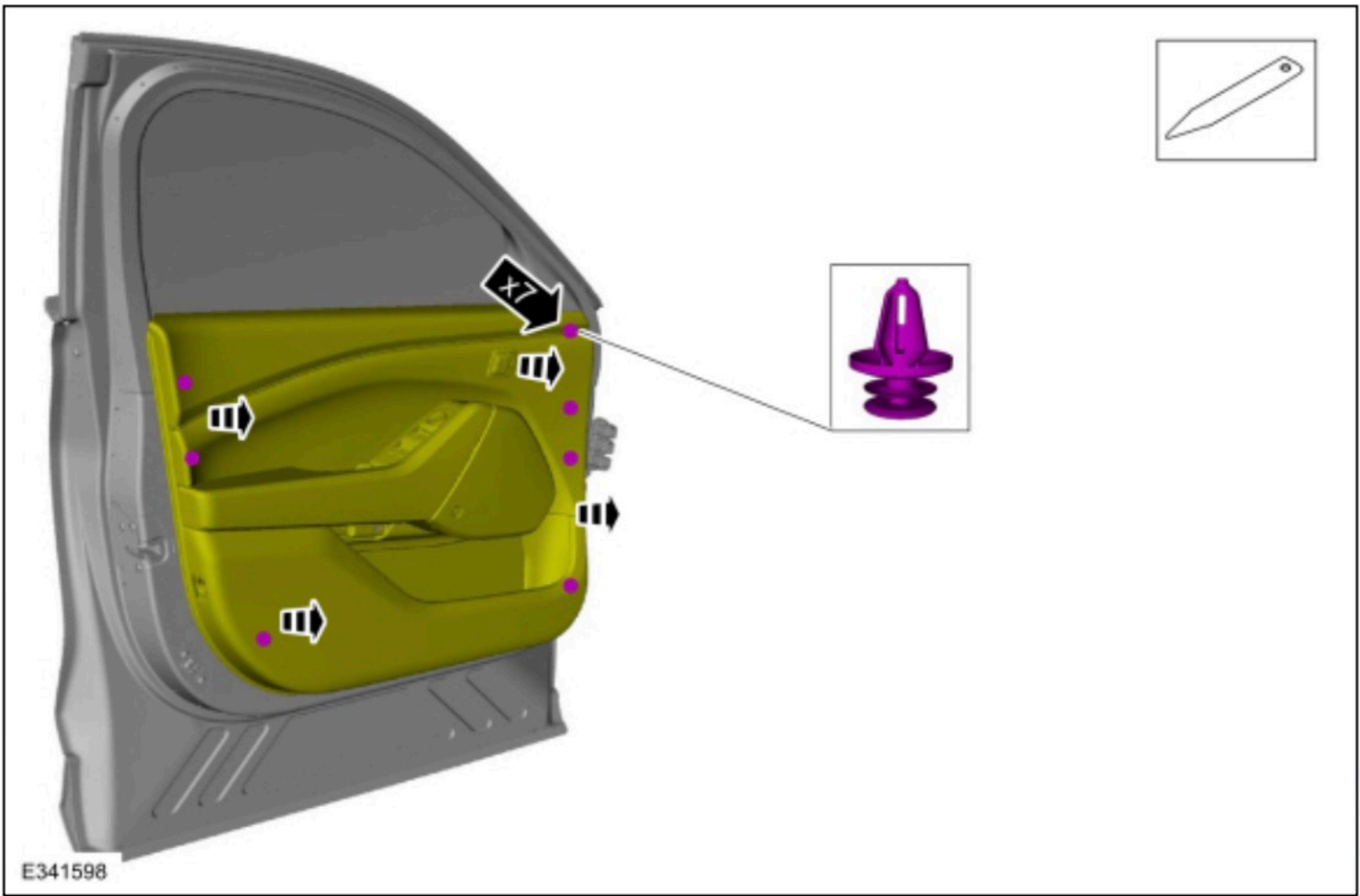

7.

Remove the front door trim panel.

1. Lift upward and outward on the front door trim panel.
2. Disconnect the front door interior cable eyelet from the front door interior handle.
3. Release the front door interior cable retaining tabs.
4. Slide the front door interior cable through the opening.
5. Disconnect the front door trim panel electrical connector.

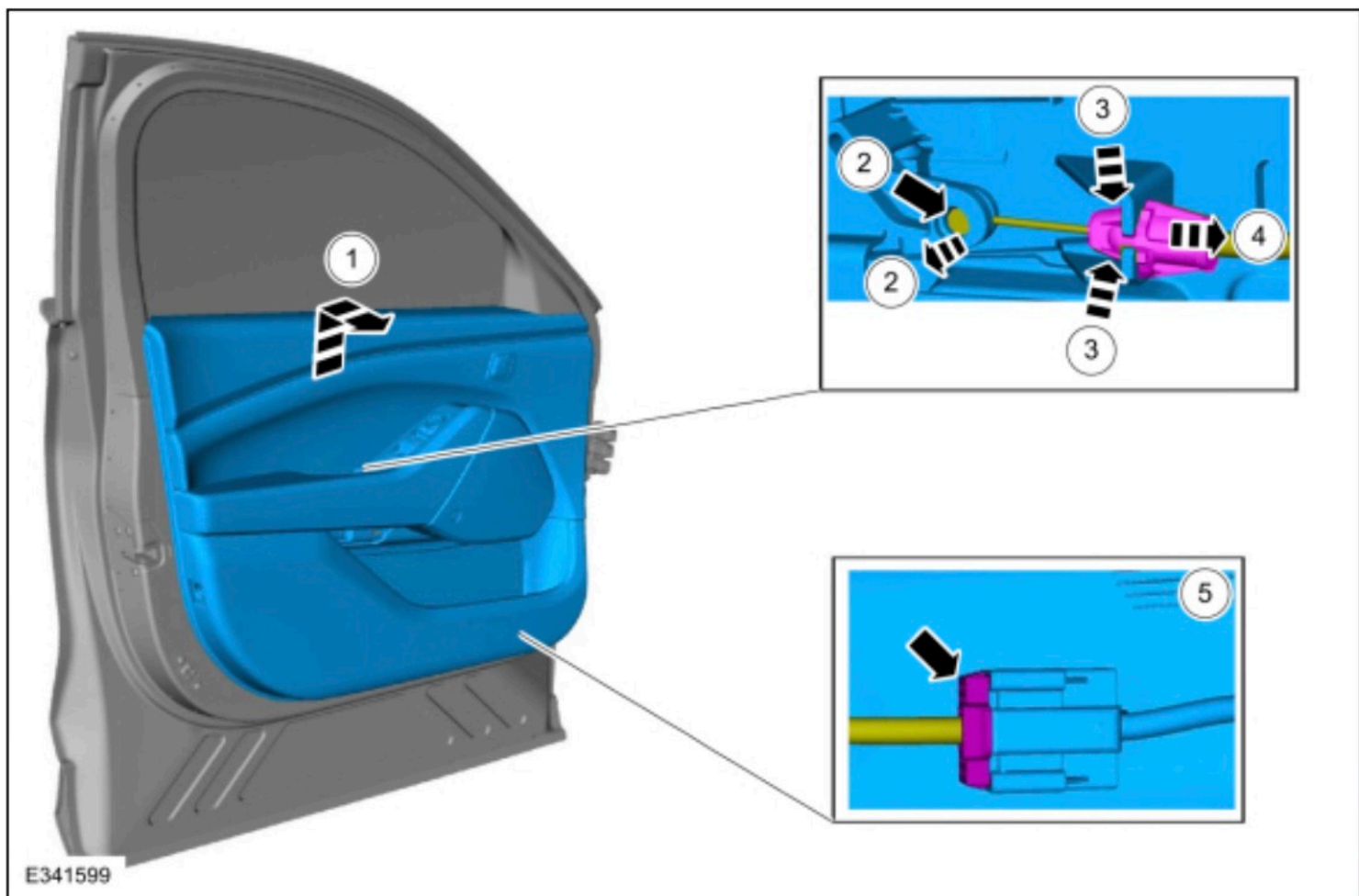

E341599

Installation

1. **NOTE:** *Transfer parts as necessary.*

To install, reverse the removal procedure.